

1. PRIORITY FORECOURT

- 2.1. EXTERNAL LIGHTING RAMP: LIBRARY: Remove existing third and sixth landscaped ramps, leaving the side of the ramp to remain, taking care in the vicinity of the existing building.
- 2.2. EXTERNAL LIGHTING RAMP: MUSEUM: Remove existing ramp to the south side of the museum building, leaving the side of the ramp to remain, taking care in the vicinity of the existing building.
- 2.3.1. Carefully remove and retain existing third and sixth landscaped ramps in situ, to be reworked in future.
- 2.3.2. Carefully remove and retain existing third and sixth landscaped ramps in situ, to be reworked in future.
- 2.4. Remove sufficient materials to create planting beds to a suitable planting depth.
- 2.5. Remove three to landscape architect's design.
- 2.6. Remove arches and edge to the ramp, retaining the ramp form in situ.
- 2.7. Carefully protect existing ramp.
- 2.8. Carefully protect existing ramp.
- 2.9. Carefully protect existing ramp.
- 2.10. Carefully protect existing ramp.
- 2.11. Carefully protect existing ramp.
- 2.12. Carefully protect existing ramp.
- 2.13. Carefully protect existing ramp.
- 2.14. Carefully protect existing ramp.
- 2.15. Carefully protect existing ramp.
- 2.16. Carefully protect existing ramp.
- 2.17. Carefully protect existing ramp.
- 2.18. Carefully protect existing ramp.
- 2.19. Carefully protect existing ramp.
- 2.20. Carefully protect existing ramp.
- 2.21. Carefully protect existing ramp.
- 2.22. Carefully protect existing ramp.
- 2.23. Carefully protect existing ramp.
- 2.24. Carefully protect existing ramp.
- 2.25. Carefully protect existing ramp.
- 2.26. Carefully protect existing ramp.
- 2.27. Carefully protect existing ramp.
- 2.28. Carefully protect existing ramp.
- 2.29. Carefully protect existing ramp.
- 2.30. Carefully protect existing ramp.
- 2.31. Carefully protect existing ramp.
- 2.32. Carefully protect existing ramp.
- 2.33. Carefully protect existing ramp.
- 2.34. Carefully protect existing ramp.
- 2.35. Carefully protect existing ramp.
- 2.36. Carefully protect existing ramp.
- 2.37. Carefully protect existing ramp.
- 2.38. Carefully protect existing ramp.
- 2.39. Carefully protect existing ramp.
- 2.40. Carefully protect existing ramp.
- 2.41. Carefully protect existing ramp.
- 2.42. Carefully protect existing ramp.
- 2.43. Carefully protect existing ramp.
- 2.44. Carefully protect existing ramp.
- 2.45. Carefully protect existing ramp.
- 2.46. Carefully protect existing ramp.
- 2.47. Carefully protect existing ramp.
- 2.48. Carefully protect existing ramp.
- 2.49. Carefully protect existing ramp.
- 2.50. Carefully protect existing ramp.

2. CHURCH HILL ENTRANCE AND EASTERN WALL

- 2.1. Remove existing wall from existing historic plan.
- 2.2. Remove existing wall from existing historic plan.
- 2.3. Remove existing wall from existing historic plan.
- 2.4. Remove existing wall from existing historic plan.
- 2.5. Remove existing wall from existing historic plan.
- 2.6. Remove existing wall from existing historic plan.
- 2.7. Remove existing wall from existing historic plan.
- 2.8. Remove existing wall from existing historic plan.
- 2.9. Remove existing wall from existing historic plan.
- 2.10. Remove existing wall from existing historic plan.
- 2.11. Remove existing wall from existing historic plan.
- 2.12. Remove existing wall from existing historic plan.
- 2.13. Remove existing wall from existing historic plan.
- 2.14. Remove existing wall from existing historic plan.
- 2.15. Remove existing wall from existing historic plan.
- 2.16. Remove existing wall from existing historic plan.
- 2.17. Remove existing wall from existing historic plan.
- 2.18. Remove existing wall from existing historic plan.
- 2.19. Remove existing wall from existing historic plan.
- 2.20. Remove existing wall from existing historic plan.
- 2.21. Remove existing wall from existing historic plan.
- 2.22. Remove existing wall from existing historic plan.
- 2.23. Remove existing wall from existing historic plan.
- 2.24. Remove existing wall from existing historic plan.
- 2.25. Remove existing wall from existing historic plan.
- 2.26. Remove existing wall from existing historic plan.
- 2.27. Remove existing wall from existing historic plan.
- 2.28. Remove existing wall from existing historic plan.
- 2.29. Remove existing wall from existing historic plan.
- 2.30. Remove existing wall from existing historic plan.
- 2.31. Remove existing wall from existing historic plan.
- 2.32. Remove existing wall from existing historic plan.
- 2.33. Remove existing wall from existing historic plan.
- 2.34. Remove existing wall from existing historic plan.
- 2.35. Remove existing wall from existing historic plan.
- 2.36. Remove existing wall from existing historic plan.
- 2.37. Remove existing wall from existing historic plan.
- 2.38. Remove existing wall from existing historic plan.
- 2.39. Remove existing wall from existing historic plan.
- 2.40. Remove existing wall from existing historic plan.

3. LIBRARY LANDSCAPE

- 3.1. Remove existing wall from existing historic plan.
- 3.2. Remove existing wall from existing historic plan.
- 3.3. Remove existing wall from existing historic plan.
- 3.4. Remove existing wall from existing historic plan.
- 3.5. Remove existing wall from existing historic plan.
- 3.6. Remove existing wall from existing historic plan.
- 3.7. Remove existing wall from existing historic plan.
- 3.8. Remove existing wall from existing historic plan.
- 3.9. Remove existing wall from existing historic plan.
- 3.10. Remove existing wall from existing historic plan.
- 3.11. Remove existing wall from existing historic plan.
- 3.12. Remove existing wall from existing historic plan.
- 3.13. Remove existing wall from existing historic plan.
- 3.14. Remove existing wall from existing historic plan.
- 3.15. Remove existing wall from existing historic plan.
- 3.16. Remove existing wall from existing historic plan.
- 3.17. Remove existing wall from existing historic plan.
- 3.18. Remove existing wall from existing historic plan.
- 3.19. Remove existing wall from existing historic plan.
- 3.20. Remove existing wall from existing historic plan.
- 3.21. Remove existing wall from existing historic plan.
- 3.22. Remove existing wall from existing historic plan.
- 3.23. Remove existing wall from existing historic plan.
- 3.24. Remove existing wall from existing historic plan.
- 3.25. Remove existing wall from existing historic plan.
- 3.26. Remove existing wall from existing historic plan.
- 3.27. Remove existing wall from existing historic plan.
- 3.28. Remove existing wall from existing historic plan.
- 3.29. Remove existing wall from existing historic plan.
- 3.30. Remove existing wall from existing historic plan.

4. PRIORITY FORECOURT

- 4.1. Remove existing wall from existing historic plan.
- 4.2. Remove existing wall from existing historic plan.
- 4.3. Remove existing wall from existing historic plan.
- 4.4. Remove existing wall from existing historic plan.
- 4.5. Remove existing wall from existing historic plan.
- 4.6. Remove existing wall from existing historic plan.
- 4.7. Remove existing wall from existing historic plan.
- 4.8. Remove existing wall from existing historic plan.
- 4.9. Remove existing wall from existing historic plan.
- 4.10. Remove existing wall from existing historic plan.
- 4.11. Remove existing wall from existing historic plan.
- 4.12. Remove existing wall from existing historic plan.
- 4.13. Remove existing wall from existing historic plan.
- 4.14. Remove existing wall from existing historic plan.
- 4.15. Remove existing wall from existing historic plan.
- 4.16. Remove existing wall from existing historic plan.
- 4.17. Remove existing wall from existing historic plan.
- 4.18. Remove existing wall from existing historic plan.
- 4.19. Remove existing wall from existing historic plan.
- 4.20. Remove existing wall from existing historic plan.
- 4.21. Remove existing wall from existing historic plan.
- 4.22. Remove existing wall from existing historic plan.
- 4.23. Remove existing wall from existing historic plan.
- 4.24. Remove existing wall from existing historic plan.
- 4.25. Remove existing wall from existing historic plan.
- 4.26. Remove existing wall from existing historic plan.
- 4.27. Remove existing wall from existing historic plan.
- 4.28. Remove existing wall from existing historic plan.
- 4.29. Remove existing wall from existing historic plan.
- 4.30. Remove existing wall from existing historic plan.

5. PRIORITY FORECOURT

- 5.1. Remove existing wall from existing historic plan.
- 5.2. Remove existing wall from existing historic plan.
- 5.3. Remove existing wall from existing historic plan.
- 5.4. Remove existing wall from existing historic plan.
- 5.5. Remove existing wall from existing historic plan.
- 5.6. Remove existing wall from existing historic plan.
- 5.7. Remove existing wall from existing historic plan.
- 5.8. Remove existing wall from existing historic plan.
- 5.9. Remove existing wall from existing historic plan.
- 5.10. Remove existing wall from existing historic plan.
- 5.11. Remove existing wall from existing historic plan.
- 5.12. Remove existing wall from existing historic plan.
- 5.13. Remove existing wall from existing historic plan.
- 5.14. Remove existing wall from existing historic plan.
- 5.15. Remove existing wall from existing historic plan.
- 5.16. Remove existing wall from existing historic plan.
- 5.17. Remove existing wall from existing historic plan.
- 5.18. Remove existing wall from existing historic plan.
- 5.19. Remove existing wall from existing historic plan.
- 5.20. Remove existing wall from existing historic plan.
- 5.21. Remove existing wall from existing historic plan.
- 5.22. Remove existing wall from existing historic plan.
- 5.23. Remove existing wall from existing historic plan.
- 5.24. Remove existing wall from existing historic plan.
- 5.25. Remove existing wall from existing historic plan.
- 5.26. Remove existing wall from existing historic plan.
- 5.27. Remove existing wall from existing historic plan.
- 5.28. Remove existing wall from existing historic plan.
- 5.29. Remove existing wall from existing historic plan.
- 5.30. Remove existing wall from existing historic plan.

6. PRIORITY FORECOURT

- 6.1. Remove existing wall from existing historic plan.
- 6.2. Remove existing wall from existing historic plan.
- 6.3. Remove existing wall from existing historic plan.
- 6.4. Remove existing wall from existing historic plan.
- 6.5. Remove existing wall from existing historic plan.
- 6.6. Remove existing wall from existing historic plan.
- 6.7. Remove existing wall from existing historic plan.
- 6.8. Remove existing wall from existing historic plan.
- 6.9. Remove existing wall from existing historic plan.
- 6.10. Remove existing wall from existing historic plan.
- 6.11. Remove existing wall from existing historic plan.
- 6.12. Remove existing wall from existing historic plan.
- 6.13. Remove existing wall from existing historic plan.
- 6.14. Remove existing wall from existing historic plan.
- 6.15. Remove existing wall from existing historic plan.
- 6.16. Remove existing wall from existing historic plan.
- 6.17. Remove existing wall from existing historic plan.
- 6.18. Remove existing wall from existing historic plan.
- 6.19. Remove existing wall from existing historic plan.
- 6.20. Remove existing wall from existing historic plan.
- 6.21. Remove existing wall from existing historic plan.
- 6.22. Remove existing wall from existing historic plan.
- 6.23. Remove existing wall from existing historic plan.
- 6.24. Remove existing wall from existing historic plan.
- 6.25. Remove existing wall from existing historic plan.
- 6.26. Remove existing wall from existing historic plan.
- 6.27. Remove existing wall from existing historic plan.
- 6.28. Remove existing wall from existing historic plan.
- 6.29. Remove existing wall from existing historic plan.
- 6.30. Remove existing wall from existing historic plan.

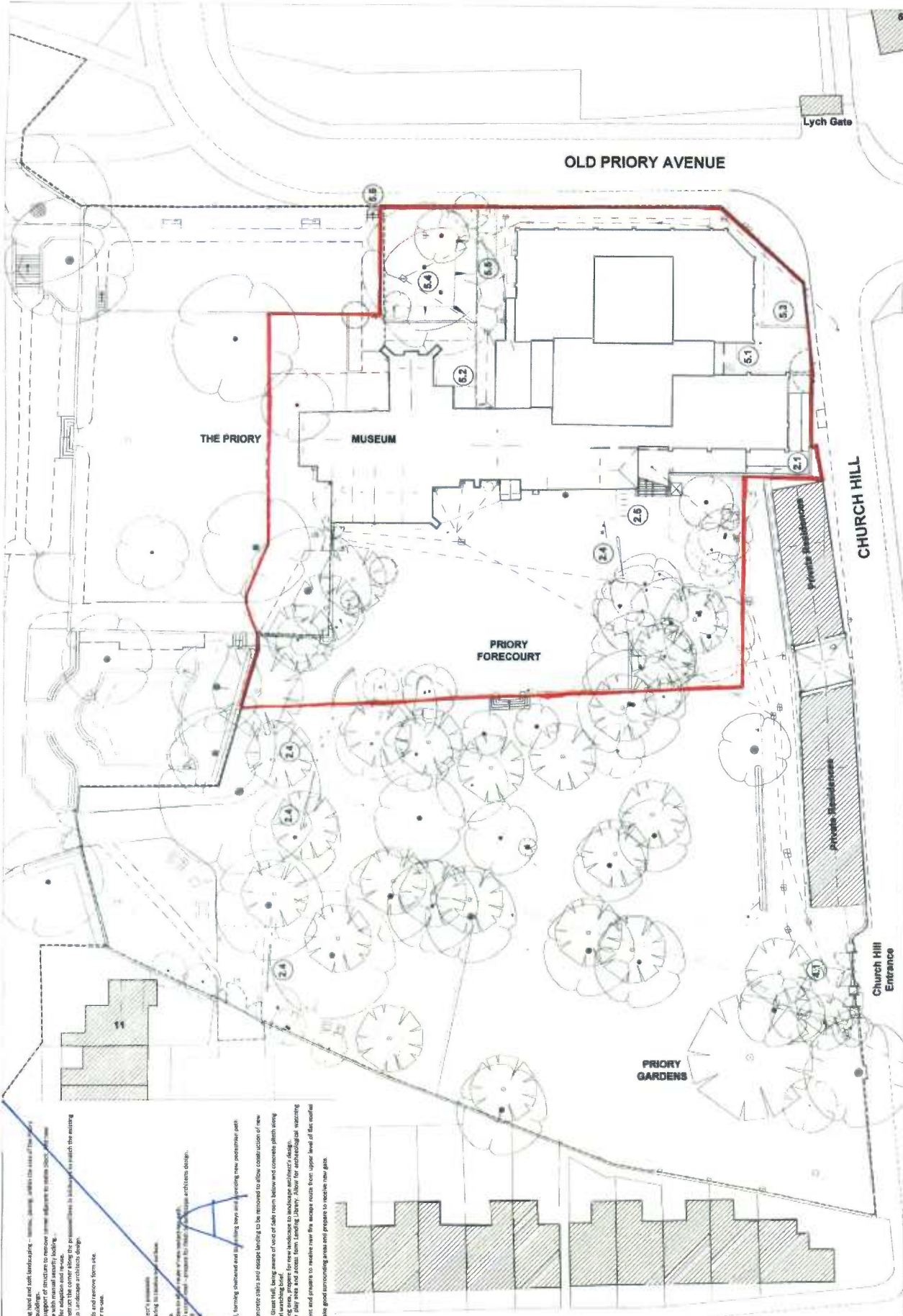

STAGED

FILE: 1.2006/A1_14000/A3
DATE: 10.04.2011
DRAWN: CC
CHECKED: CC
PROJECT: The London Borough of Bromley
PROJECT TITLE: The Priory Museum, Church Hill, Crayford BR9 6DH
DRAWING TITLE: Site Plan SURVEY - Showing Details and Alterations
SCALE: 0:46 100 C

CAROE ARCHITECTURE

THE LONDON BOROUGH OF BROMLEY
139, CHURCH HILL, CRAYFORD BR9 6DH
TEL: 0181 606 1500
WWW.CAROE.CO.UK

General Note:
Never scale dimensions from this drawing. Use written dimensions only.
Report any discrepancies, Ask for detail. Always use latest revision.
Dimensions are shown in millimetres unless otherwise stated.
Permanently important, with other information from GA, and other consultants.
DEMOLITION ITEMS THICK

1:2500

0 5m

Revision:

Rev.	Date	Description
01	05.05.14	CC
02	05.05.14	CC
03	05.05.14	CC
04	05.05.14	CC

DESCRIPTION:
STAGE D UPDATE
PLANNING

Client: CC
Drawn: CC
Checked: CC



Rev.	Date	By	Check	Drawn
1	2014 05 23	CD	CD	CD
2	2014 05 23	CD	CD	CD

Disposition
 PLANNING
 CD
 CD
 CD
 CD

General Notes:
 Never scale dimensions from this drawing. Use written dimensions only.
 Note that this drawing is based on a combination of dimensions
 surveys by others, therefore site verification of dimensional information is
 needed in conjunction with other information from CAI and other consultants.

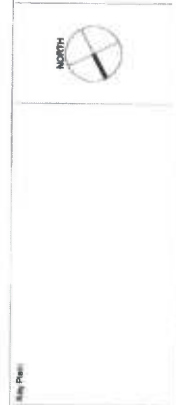

STAGE D
 The London Borough of Bromley
 PROJECT
 Church Hill, Crayford, RM8 6PH
 DRAWING TITLE
 Location Plan
 SCALE
 1:25 @ A1 - 1:125 @ A3
 DRAWN
 CD
 CHECKED
 CD
 DATE
 2014 05 23
 REVISION
 046 050 B
CAROE
 ARCHITECTURE
 CAROE ARCHITECTURE LTD.
 OFFICE: UNIT 23-24, DUNDEE ST.
 CAMBRIDGE CB2 3LQ
 TEL: 01223 472771
 FAX: 01223 474049
 WWW.CAROE.COM